

- 1-CAMERA DE ZI
- 2-BUCATARIE
- 3-DORMITOR
- 4-BAIE
- 5-TERASA

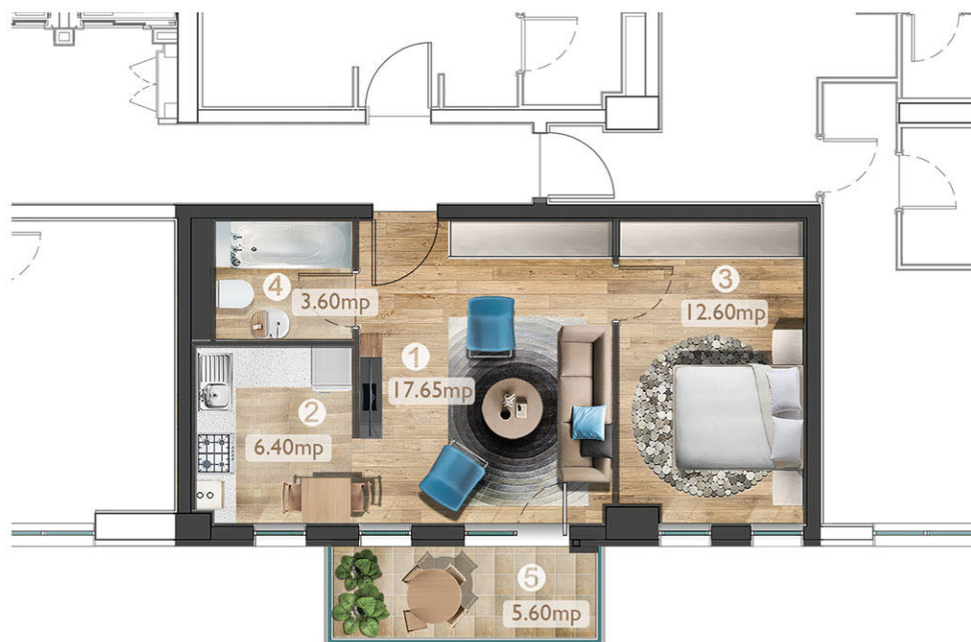

SUPR. UTILA AP.	40.30 mp
SUPR. CONSTR. APT.	49.00 mp
SUPR. CONSTR. TERASA	5.60 mp
TOTAL CONSTR.	54.60 mp